

# ASSEMBLY DOCTOR for GASTON (Incl. Driver)

Design by CARL HAGERLING for DARK

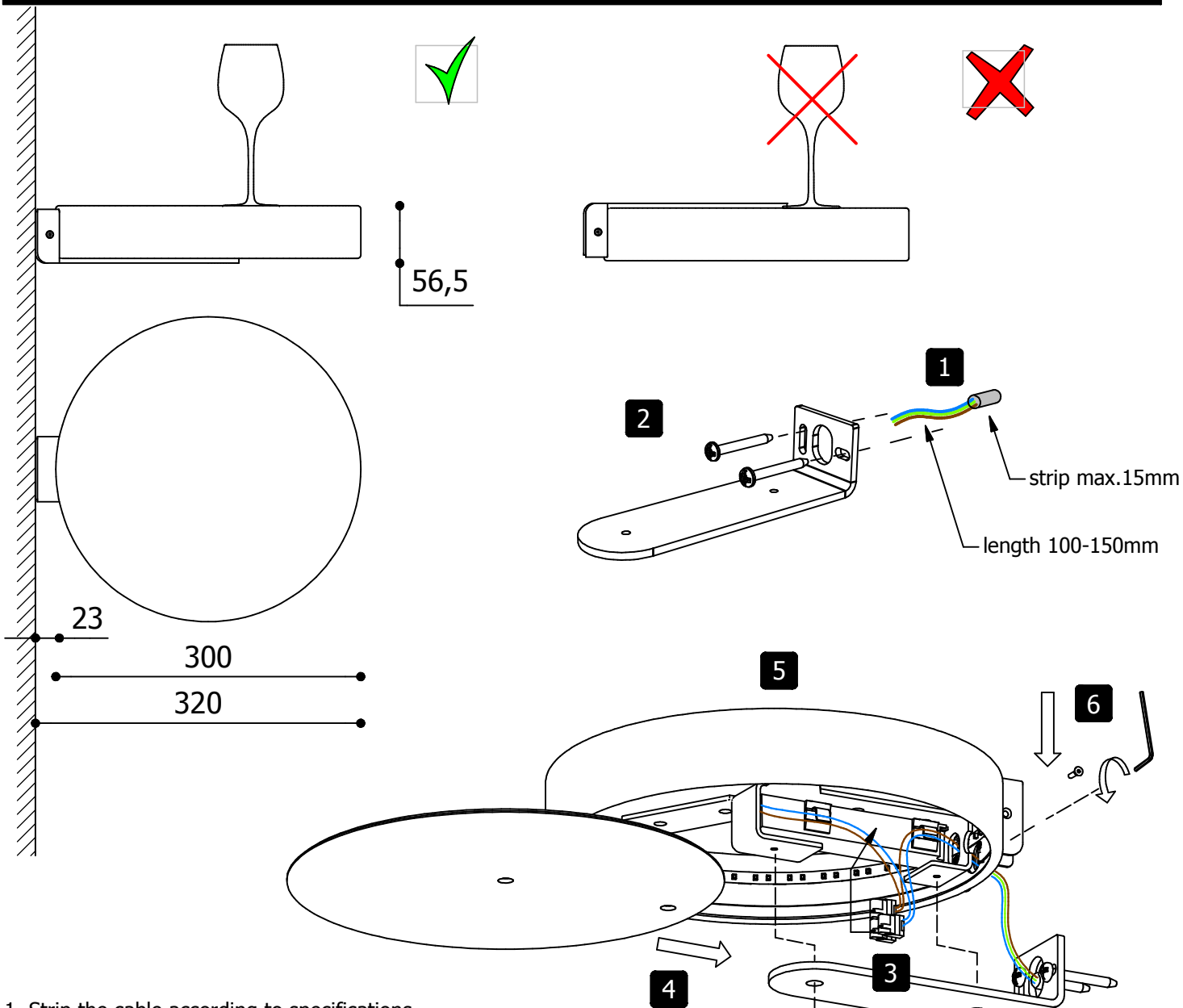

1. Strip the cable according to specifications.
2. Mount the wall bracket with 2 screws or bolts onto the wall.
3. Connect the power supply. Fixate all cables and connectors in the cable clamps.
4. Place the Gaston diffuser.
5. Place the plateau assembly and fixate both on the wall brackets with two screws from beneath.
6. Mount the Gaston cover bracket with two screws from the sides.

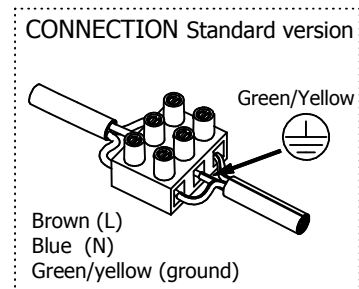

**DARK** <<  
www.dark.be

Dark at night  
Vliegplein 43 - 9991 Maldegem  
Belgium - Europe

tel +32(0)50/71.81.40  
fax +32(0)50/71.81.38  
mail info@dark.be

<b>15</b> Watt	3000 K	<b>CE</b>	NO UV/IR	>80 CRI	960 °C		INCL DRIVER	960 °C
LED	600 Lm		PC		IP 20			