

Assembly doctor TSJOEPY

Design by Anthony Duffeleer for DARK

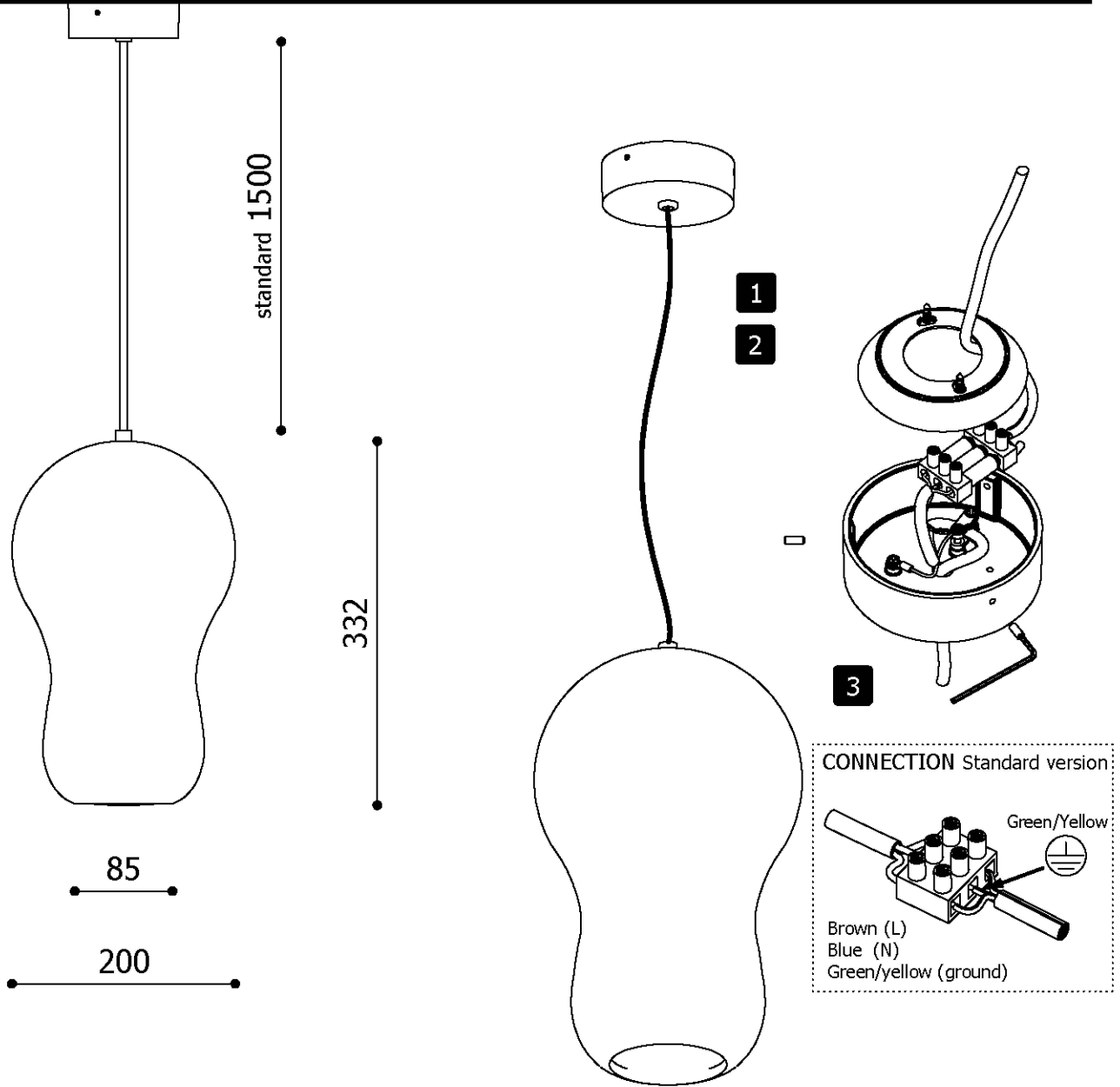

1. Mount the ceiling bracket with 2 screws onto the ceiling.
2. Adjust the fixture to the preferred height and fasten the strainrelief.
3. Connect the power supply and close the ceiling base.
4. (re)place the lamp. Respect the wattage.

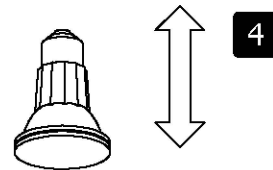

Dark at night
 Vliegplein 43 - 9991 Maldegem
 Belgium - Europe

tel +32(0)50/71.81.40
 fax +32(0)50/71.81.38
 mail info@dark.be

lamp possibilities:

	max 50 Watt	E27	INCL GEAR
	max 35 Watt	E27	
	max 11 Watt	E27	
