

# ASSEMBLY DOCTOR MAGNIFIQUE

design dark studio for dark

TRIMLESS  
GYPSUM

1

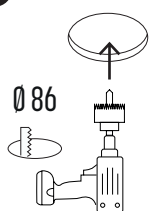

2

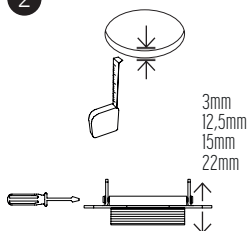

3

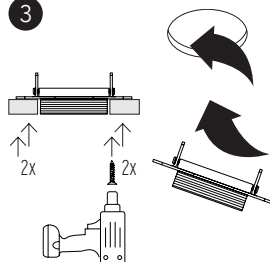

4

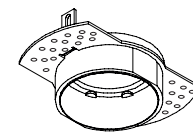

5

MOUNT  
PLUG

TRIMLESS

TRIMLESS  
CONCRETE A

1A

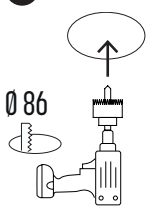

2A

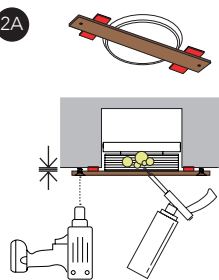

1B

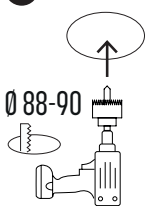

2B

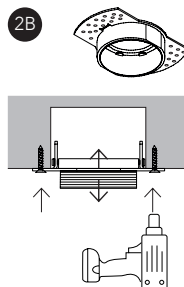

- 1 Make an opening of diameter 86mm in the ceiling (1 - 1A), or diameter 88/90mm (1B).
- 2+3 Adjust the PLUG to the ceiling thickness + 2 mm(plaster thickness). Insert the PLUG into the opening in the ceiling. Screw on to the ceiling.
- 2A Use a wood piece, space it with glazing blocks to the plaster thickness, fixate the mount plug without metal wings with PUR foam. Remove the wood piece when PUR is dried.
- 2B Screw the mount plug in the concrete ceiling. Adjust the PLUG to the plaster thickness.
- 4 Plaster (use a 2 component filler) the rim between the PLUG and the ceiling. Keep the PLUG opening clean.
- 5 Paint the ceiling. For a perfect finish between PLUG and ceiling : leave a gap of 3mm between PLUG and ceiling and fill this gap with an elastic filler.

TRIM

3A

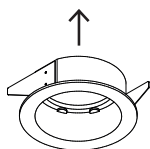
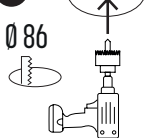

DEEP

7

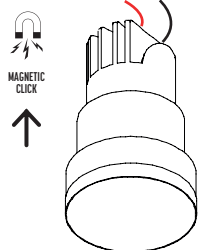

MOVE

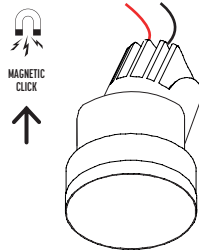

COUCOU

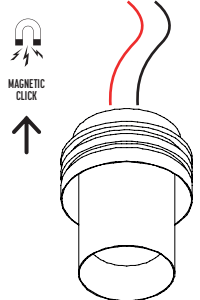

## INSTALL LIGHT FIXTURE

7. Connect the Led module or retrofit lamp and insert the module,

### DEEP - MOVE - COUCOU

- 7.1. Connect the power supply. Pay attention to the polarity. Put the driver on the ceiling.
- 7.2. Click in the magnetic PLUG.
- 7.3. Put the power on.



!!! Never connect the fixture on 220-240V ac without driver. Lighting fixture is constant current driven. Always connect constant current leds in serial connection.

### BULB

- 7.1. Connect the E27 to the power supply.
- 7.2. Click in the magnetic PLUG.
- 7.3. Place the lightbulb and put the power on.

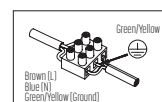

### LOFTR

- 7.1. Connect the power supply. Pay attention to the polarity. Put the driver on the ceiling.
- 7.2. Add weight of the fixture.
- 7.3. Click in the magnetic PLUG.
- 7.4. Put the power on.



!!! Never connect the fixture on 220-240V ac without driver. Lighting fixture is constant current driven. Always connect constant current leds in serial connection.

### PULL

- 7.1. assembly doctor of the Dark lighting fixture.

The load force should be four times of the weight for the whole fixture. Max load force is force is 4.3 kg,so the max insert weight should not exceed 1.6 kg

BULB

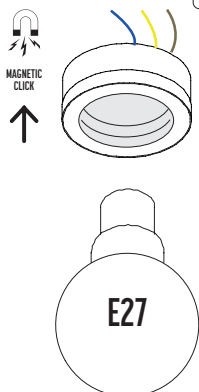

LOFTR

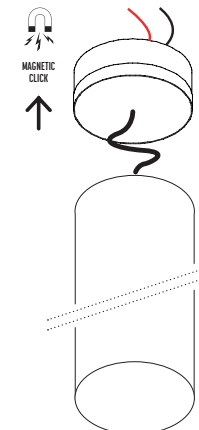

PULL

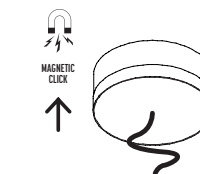

Add your magnetic click compatible Dark lighting suspension  
-  
See assembly doctor



# DARK®

© DARK 2021 / DARK has the right to change any technical data, dimensions, colors and characteristics without prior notice. All rights reserved. Please always check the latest technical data sheet on [www.dark.be](http://www.dark.be).

DARK at night nv  
Vliegplein 43 / 9991 Maldegem / Belgium  
+32 50 71 81 40 / [info@dark.be](mailto:info@dark.be) / [www.dark.be](http://www.dark.be)