

# ASSEMBLY DOCTOR BALLZZZ STRAIGHT

design dark studio for dark

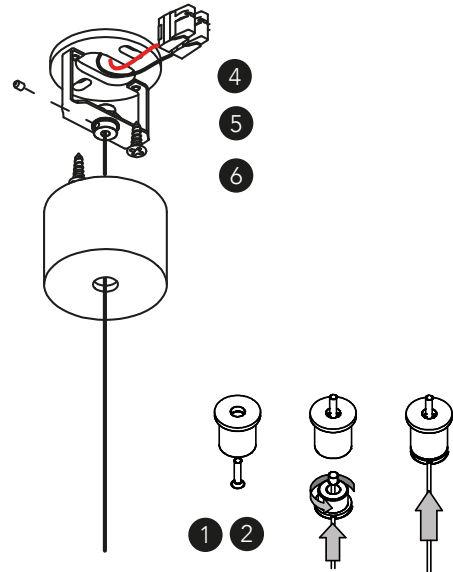

3

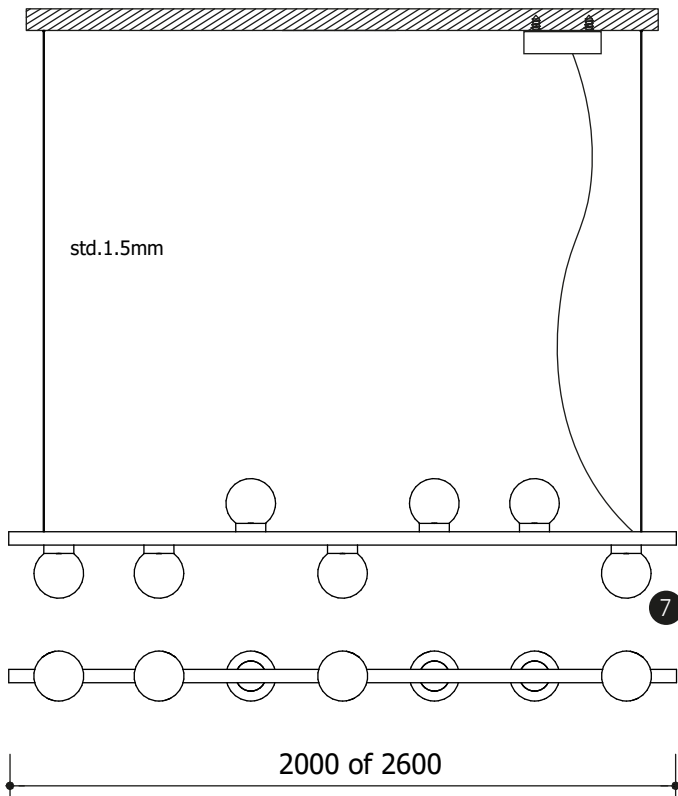
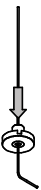

- 1 Screw the gripper body onto the ceiling.
- 2 Put in the cable and turn the top piece into the gripper body.
- 3 Lock the cable on the preferred height.
- 4 Mount the ceiling bracket with two screws onto the ceiling.
- 5 Adjust the fixture to the preferred height and fasten the strainrelief.
- 6 Connect a driver. Connect the power supply and close the ceiling base.
- 7 Screw on the glass spheres.
- 8 Put on the power.

## LIGHT SOURCE

Touching the LED can result in permanent damage of the light source.  
The light source contained in this luminaire shall only be replaced by the manufacturer or his service agent or a similar qualified person.  
Always be properly grounded when touching leads or circuitry inside the luminaire.

### !!! Never connect the fixture on 220-240V ac without driver.

Lighting fixture is constant current driven.  
For drivers purchase, contact your sales contact.  
Always connect constant current leds in serial connection.

Check catalogue P 488-489 (Installation of LED)

## COAX CABLE



### CONNECTION Standard version

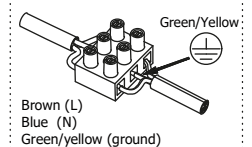

### CONNECTION Dimmable version

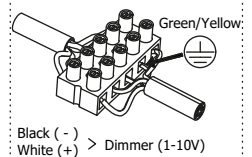

LED-CONNECTION			
RED	WHITE	BROWN	+
BLACK	GREY	BLUE	-

Alu / Glass

