

# ASSEMBLY DOCTOR GAZTA WALL

design Vincent Van Laere

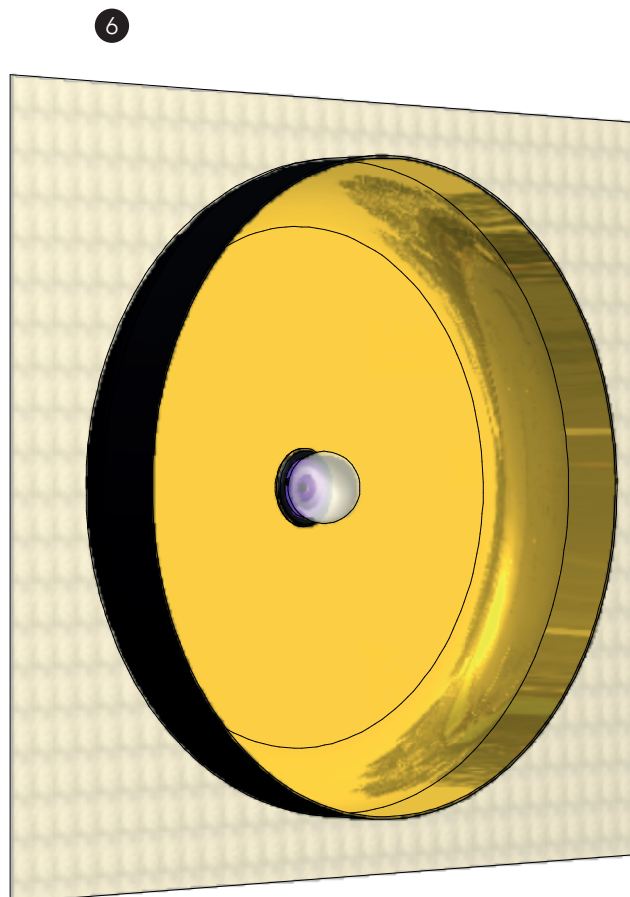
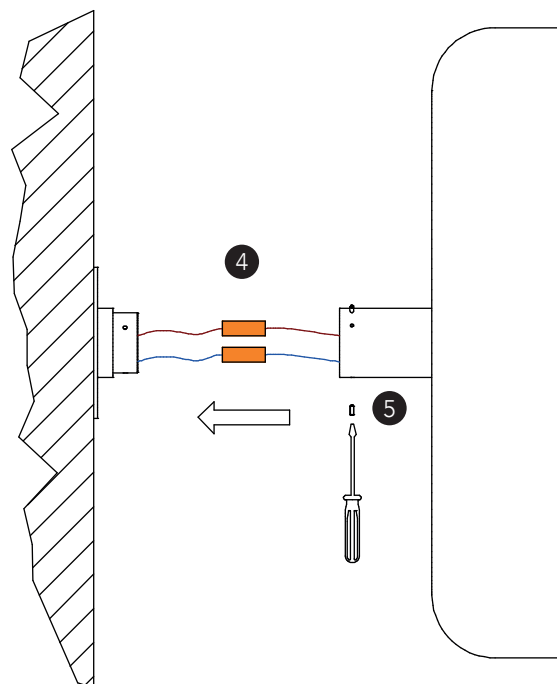
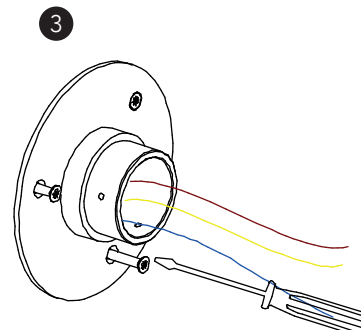
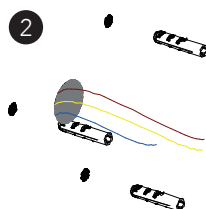
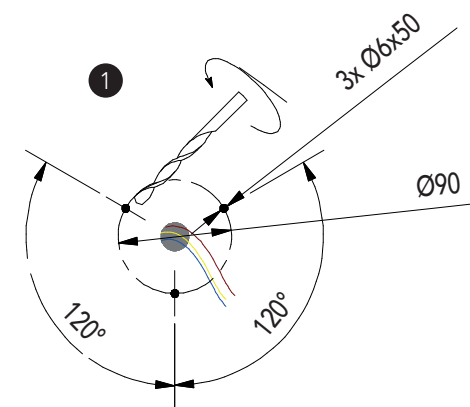

- 1 Mark the hole pattern and drill the 3 holes (drill Ø6mm).
- 2 Insert plugs in the holes.
- 3 Mount the base on the wall.
- 4 Connect wiring.
- 5 Mount fixture on the base and with set screws.
- 6 Result

Alu-Brass

